

SECTION Y-Y' & ELEVATION B

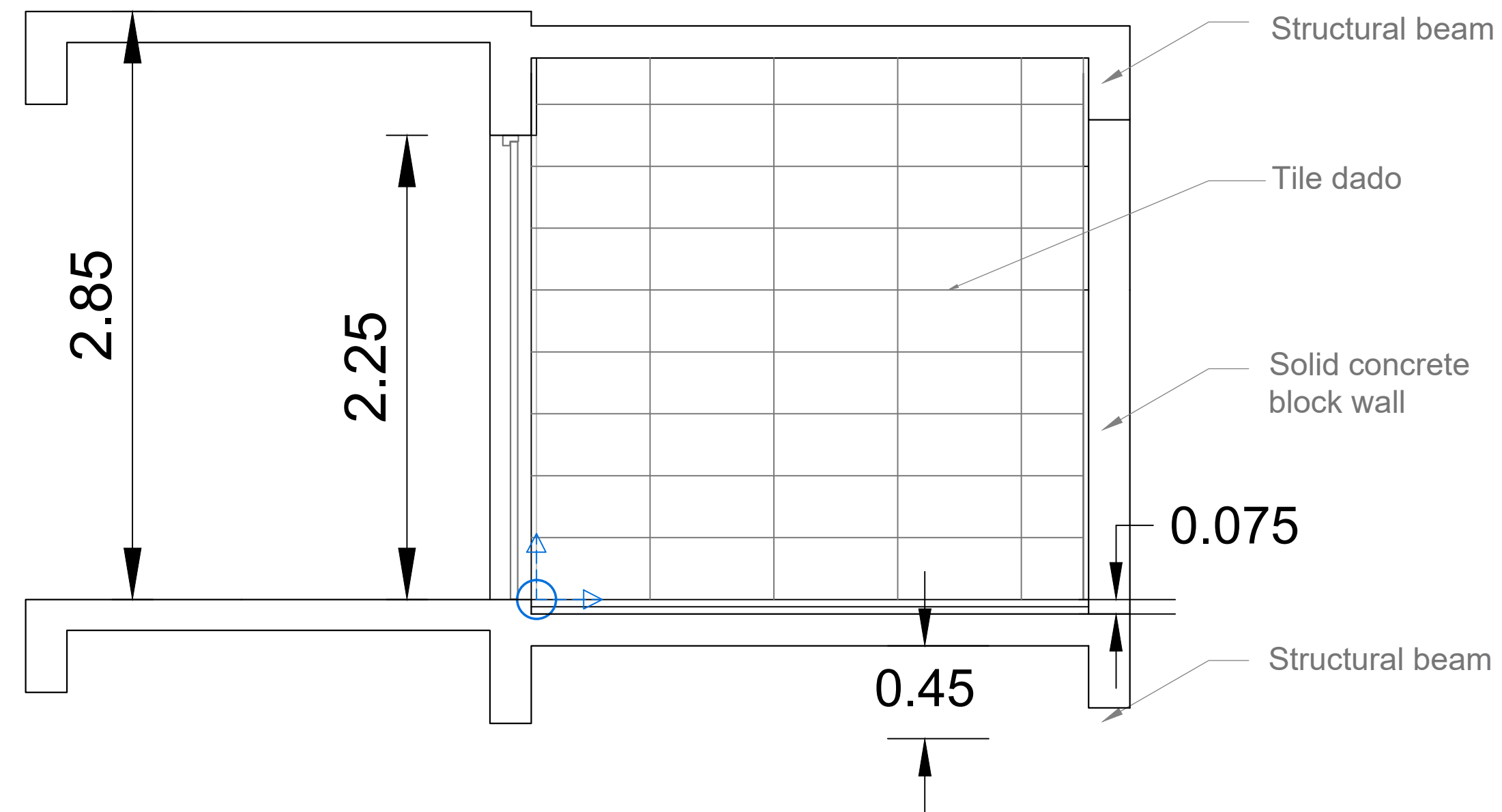

SECTION X-X' & ELEVATION D

TYPICAL TOILET SECTIONAL ELEVATION

NOTE :

All dimensions are in metre (m) and areas in metre square (sqm) unless specified otherwise

ORIENTATION :

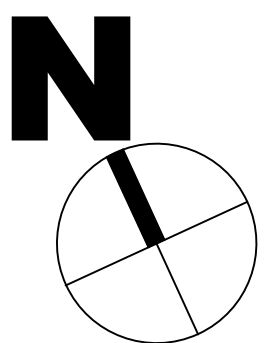

CLIENT:

NATIONAL LAW SCHOOL INDIA UNIVERSITY
BENGALURU, KARNATAKA

JOB TITLE:

PROPOSED CONSTRUCTION OF STAFF
QUARTERS FOR NLSIU IN SFSH MR 47,48,49 IN
NANDINI LAYOUT , BANGALORE

DRAWING:

TOILET AND LIFT
CLADDING DETAIL

SCALE : 1:50

DEALT: HEMANTH.K.S

DATE : 17-02-2024

CHECKED: MANISHA
VASAN

KAREKAR AND ASSOCIATES

ARCHITECTS, INTERIOR DESIGNERS, AND
STRUCTURAL ENGINEERING CONSULTANTS
NO. 282, KAREKARS, 14TH CROSS, HIG, DOLLARS
COLONY, RMV 2ND STAGE
BANGALORE - 560054

DRAWING NO.

NLS/NANDINI/TOILET-LIFT DETAILS

R0

SHEET NO. : 06

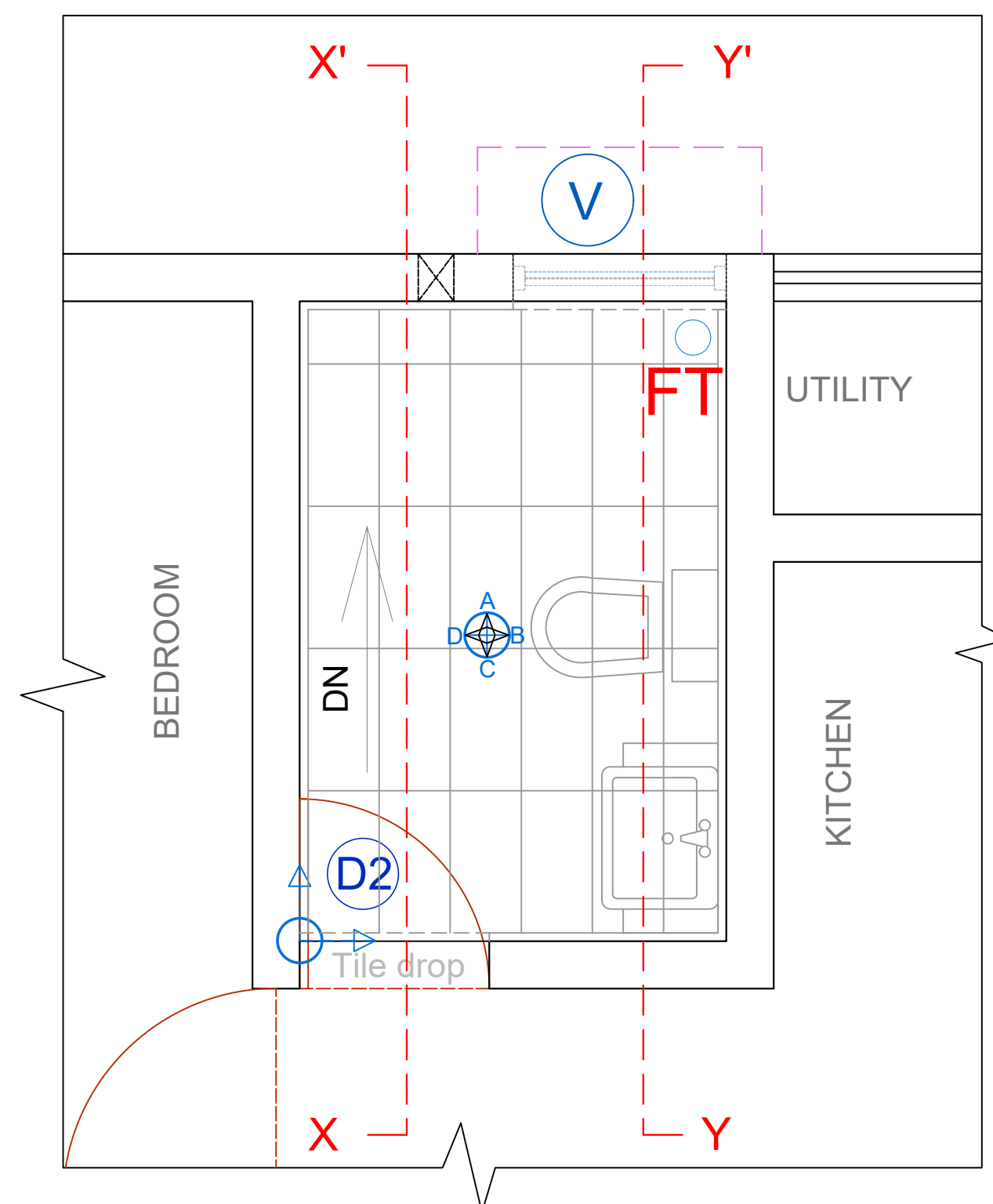

TYPICAL TOILET PLAN

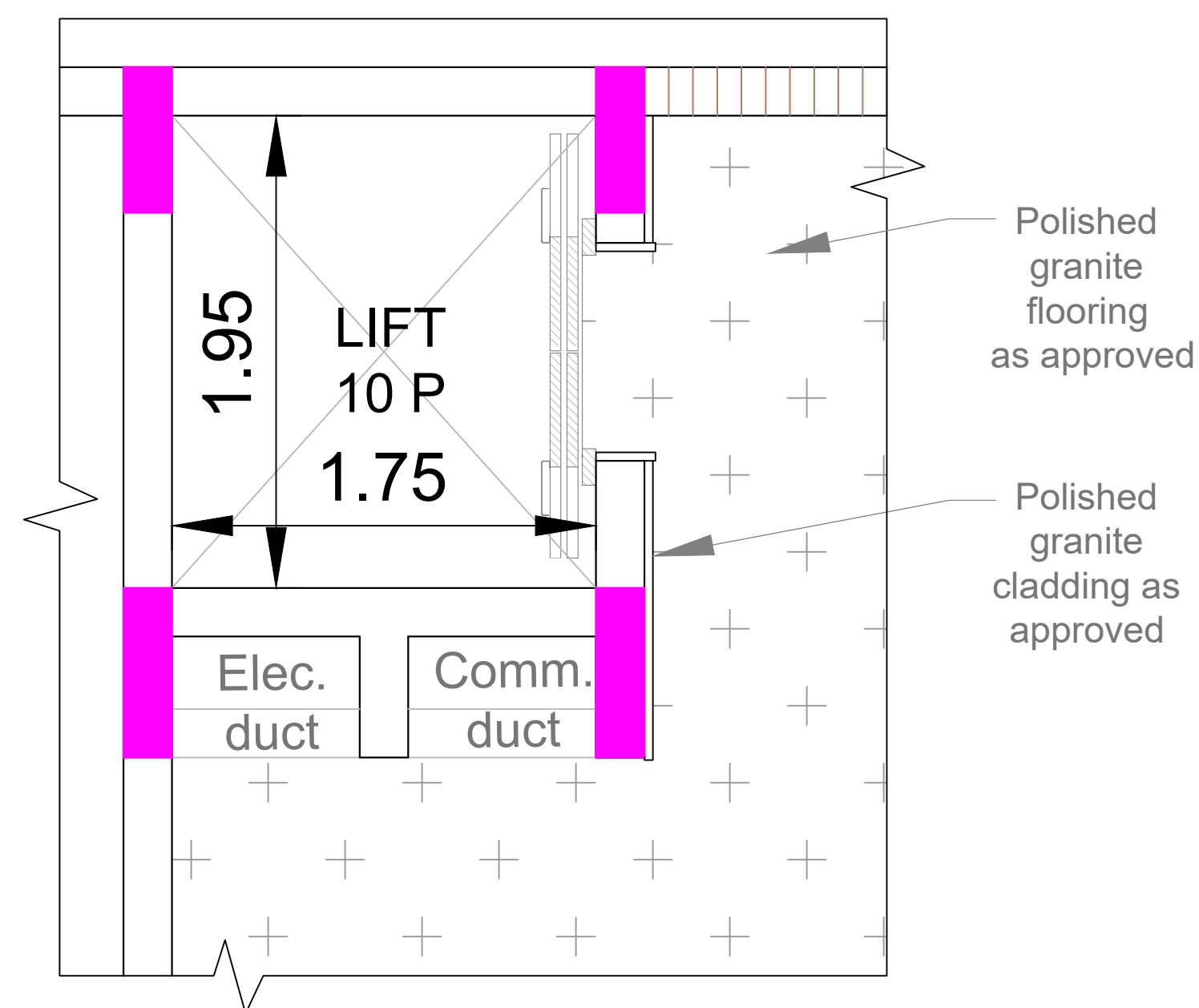

TYPICAL LIFT PLAN

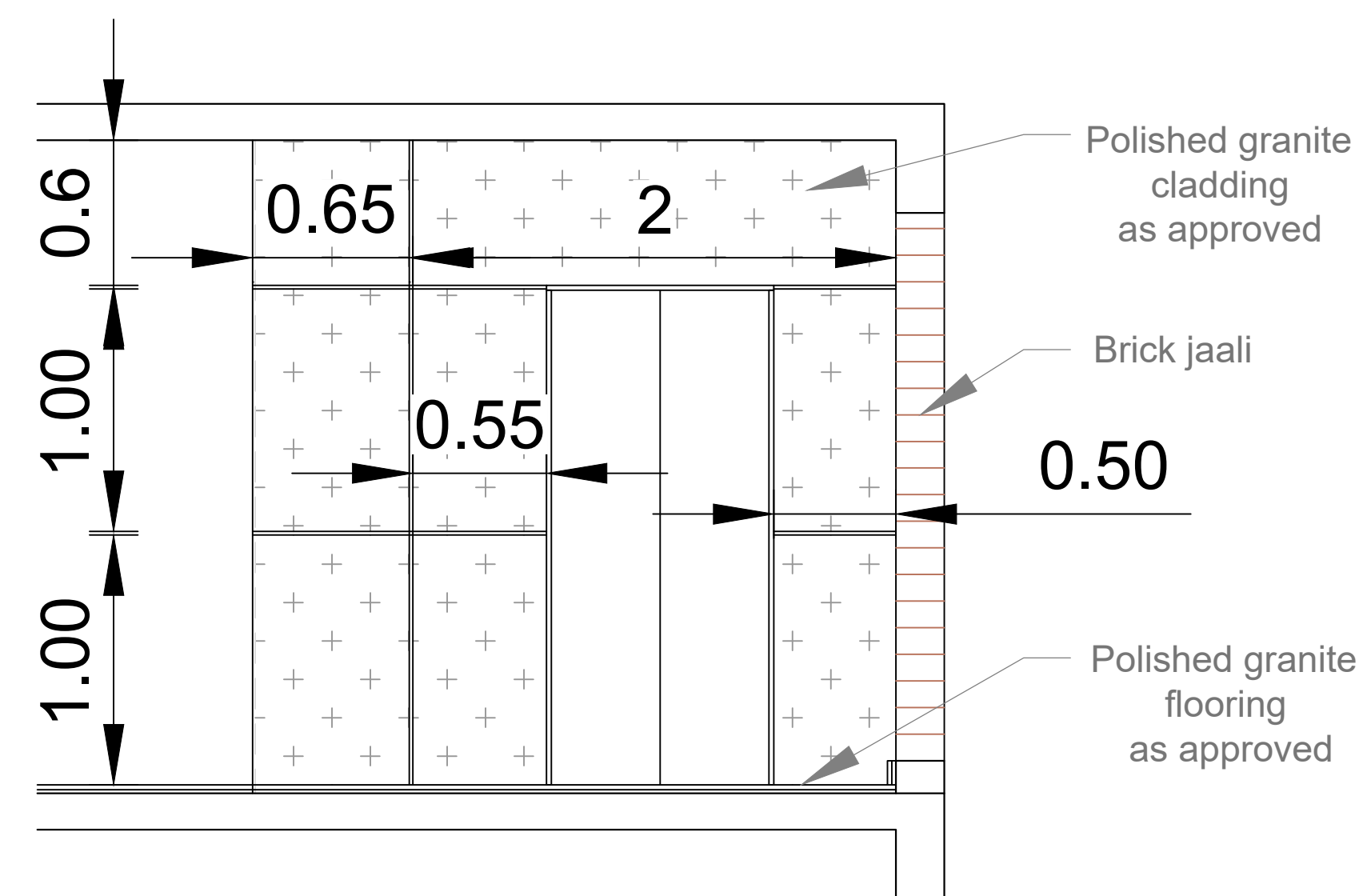

ELEVATION

LIFT CLADDING DETAIL